

Historic Resources Inventory

Property name, historic

Property name, common:

Street Address: 102 Jackson Street, South

Descriptive Location (Rural address):

Legal Description: Map 643-F, Block 86, Parcel 256

Former/Historic Use: Residential: single dwelling

Present Use: Residential: single dwelling

Date of Construction: c.1930

Date(s) of historic changes, if any:

Post-historic changes and date(s):

Architect:

Builder:

Brief Description:

One-story, stucco Tudor with a steep, side-gable roof of asphalt shingles on a stucco foundation. The gable end has decorative half-timbering with curved timbers and decorative, louvered vents in the gable end and Tudor-arch, louvered vents in the secondary gables. A large, front-facing gable projects to form a centered porch on the façade (E), which is supported by painted brick piers and painted brick pilasters. A 15-light wood door with a 4-light transom and 6/6 wood-frame window are all located under the porch. Two, 6/6 wood-frame windows flank the porch and a low, open, painted brick knee wall with a concrete cap encloses the area outside of the porch.

Outbuildings or secondary elements (if significant, use separate form)

One-story, board-and-batten storage or guest house with a gable roof of asphalt shingles and an E porch on wood posts. There is a 4/4 wood-frame window in the S elevation. (C)

Historical Information:



MDAH Inventory Code

County: Tippah

City: Ripley

USGS Quad map:

Survey Seq. #: 88

Ownership: Private

Interior surveyed? No

Integrity: Some changes

Style: Tudor

Form:

Sources: Sanborn maps, 1943.

Contexts:

Owner:

Photographer: David Preziosi, MHT

Photo No/Date: 4422:22 / Nov 2003

Form by: Deborah Wise Oakley, MHT

Survey project: Ripley Survey

Form completed: 23 Jun 2004

Registration Status and Dates

NHL:

Listed NR:

Federal DOE:

District Name: Ripley

Contributing

Non-Contributing

Previously Listed

Element no. 88

Map and Record

WEST JEFFERSON ST.

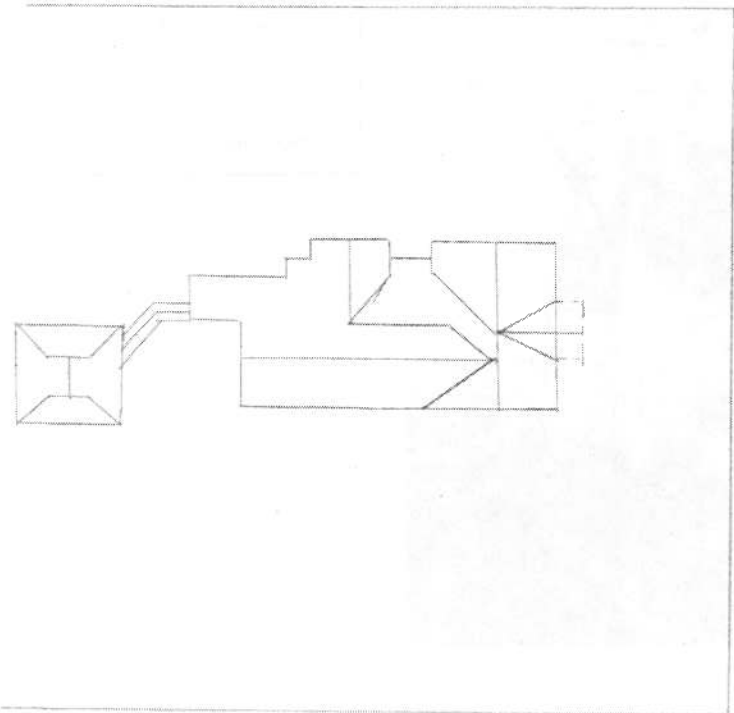

SOUTH JACKSON ST.

WEST WALNUT ST.

