

Historic Resources Inventory

Property name, historic

Property name, common:

Street Address: 102 Water Street, East

Descriptive Location (Rural address):

Legal Description: Map 643-F, Block 32, Parcel 365

Former/Historic Use:

Present Use:

Date of Construction: c. 1920

Date(s) of historic changes, if any:

Post-historic changes and date(s):

Architect:

Builder:

Brief Description:

One-and-a-half story, with aluminum siding and a side-gable roof of asphalt shingles on a concrete block foundation. The façade (N) has a shed porch supported by decorative metal posts, which shelters a center wood door, which is flanked by 6/6 metal-frame windows outside the porch. A 6/6 metal-frame window is in the gable end.

Outbuildings or secondary elements (if significant, use separate form)

Historical Information:



MDAH Inventory Code

County: Tippah

City: Ripley

USGS Quad map:

Survey Seq. #: 253

Ownership: Private

Interior surveyed? No

Integrity: Some changes

Style:

Form:

Sources: Sanborn maps, 1925, 1943.

Contexts:

Owner:

Photographer: David Preziosi, MHT

Photo No/Date: 4420:5 / Nov 2003

Form by: Deborah Wise Oakley, MHT

Survey project: Ripley Survey

Form completed: 23 Jun 2004

Registration Status and Dates

NHL:

Listed NR:

Federal DOE:

District Name: Ripley

- Contributing
 Non-Contributing
 Previously Listed

Element no. 253

EAST WATER ST.

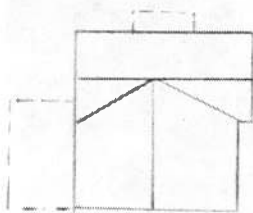

SOUTH COMMERCE ST.

