

Historic Resources Inventory

Property name, historic: Jeffries Garage
Property name, common: R.L. Vance Hardware
Street Address: 106A Commerce Street, North
Descriptive Location (Rural address):
Legal Description: Map 643-F, Block 18, Parcel 300
Former/Historic Use: Commercial: small commercial building
Present Use: Commercial: small commercial building
Date of Construction: c.1920
Date(s) of historic changes, if any:
Post-historic changes and date(s):
Architect: Builder:

Brief Description:

One-story, painted-brick commercial building with flat parapet topped by a stucco cap and dentiled cornice. A slightly recessed brick section is at the center of the upper wall, forming a signboard, just above the pent metal awning. Storefront is mostly original, with central recessed entrance flanked by two display windows, slanting back to form showcases. Entrance is a 1-light and 1-panel wood door with 2-light transom, while plate-glass display windows are topped by 2-light transoms and soldier-course lintels and surmount recessed-panel bulkheads. A single-leaf door, also 1-light and 1-panel, with 1-light transom is at either end of the façade. Beadboard ceiling in entryway and on interior. Wood floor.

Outbuildings or secondary elements (if significant, use separate form)

Historical Information:

Built as Jeffries Garage in 1919, but became R.L. Vance & Co. (furniture and hardware) in 1922. Southern Sentinel, Feb. 2, 1922.

MDAH Inventory Code

County: Tippah
City: Ripley
USGS Quad map:
Survey Seq. #: 17
Ownership: Private
Interior surveyed? No
Integrity: Some changes
Style:
Form:

Sources: Mr. R.L. Vance, Nov. 17, 2003. Sanborn maps, 1925, 1943.

Contexts:

Owner:

Photographer: David Preziosi, MHT

Photo No/Date: 4416:15 / Nov 2003

Form by: Deborah Wise Oakley, MHT

Survey project: Ripley Survey

Form completed: 17 Nov 2003

Registration Status and Dates

NHL:

Listed NR:

Federal DOE:

District Name: Ripley

- Contributing
- Non-Contributing
- Previously Listed

Element no. 17



EAST SPRING ST

NORTH COMMERCE ST.

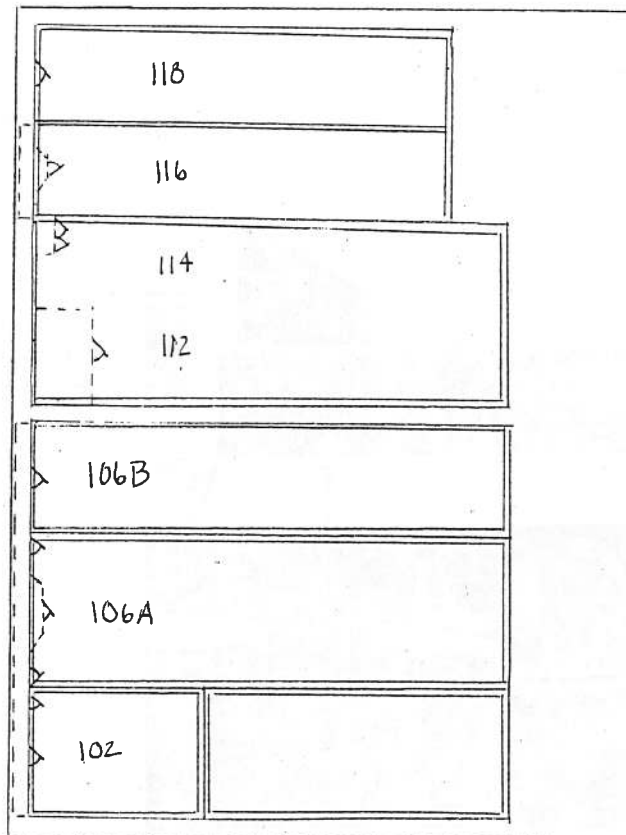

EAST JEFFERSON ST.