

# Historic Resources Inventory

**Property name, historic**

**Property name, common:**

**Street Address:** 113 Spring Street, East

**Descriptive Location (Rural address):**

**Legal Description:** Map 643-F, Block 13, Parcel 191

**Former/Historic Use:** Commercial: small commercial building

**Present Use:** Commercial: small commercial building

**Date of Construction:** c. 1945

**Date(s) of historic changes, if any:**

**Post-historic changes and date(s):**

**Architect:**

**Builder:**

**Brief Description:**

Two-story, painted-brick (stretched bond) commercial building with flat parapet topped by metal coping. Second story has four bays, each an 8/4 (originally 8/8) steel-framed DHS with applied dentiled lintel and paneled bulkhead infill at the bottom half of the lower sash. Flat metal awning shelters first-story storefront, which consists of a center recessed glazed metal door with sidelight entry between two stepped back aluminum-frame showcase windows with rough stucco bulkheads.

**Outbuildings or secondary elements (if significant, use separate form)**

**Historical Information:**



**MDAH Inventory Code**

**County:** Tippah

**City:** Ripley

**USGS Quad map:**

**Survey Seq. #:** 217

**Ownership:** Private

**Interior surveyed?** No

**Integrity:** Some changes

**Style:**

**Form:**

**Sources:** Sanborn maps, 1943.

**Contexts:**

**Owner:**

**Photographer:** David Preziosi, MHT

**Photo No/Date:** 4416:3A / Nov 2003

**Form by:** Deborah Wise Oakley, MHT

**Survey project:** Ripley Survey

**Form completed:** 17 Nov 2003

**Registration Status and Dates**

**NHL:**

**Listed NR:**

**Federal DOE:**

**District Name:** Ripley

Contributing

Non-Contributing

Previously Listed

**Element no.** 217

NORTH MAIN ST.

NORTH COMMERCE ST.

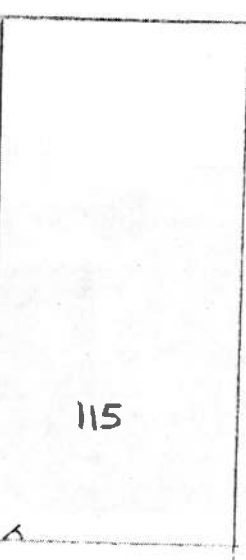
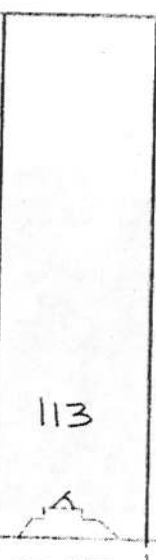
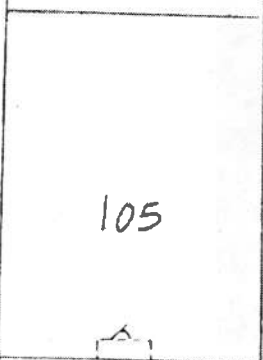
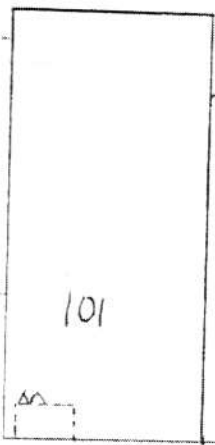

EAST SPRING ST.

