

# Historic Resources Inventory

**Property name, historic**

Property name, common:

Street Address: 116 Mulberry Street, West

Descriptive Location (Rural address):

Legal Description: Map 643-F, Block 7, Parcel 177

Former/Historic Use: Residential: single dwelling

Present Use: Residential: single dwelling

Date of Construction: c.1935

Date(s) of historic changes, if any:

Post-historic changes and date(s):

Architect:

Builder:

**Brief Description:**

One-story, wide-clapboard with a side-gable roof of tan, asphalt shingles on a stucco foundation. A front-facing gable projects to form a vestibule with a round-arch entry, while the right side extends downward to include a front-facing, brick chimney, which has been cut off at the roof line. The façade (S) has asymmetrical fenestration with paired windows to the far left, an 8-light and 1-panel wood door in the vestibule and 2 single windows to the right. All windows are 6/6 wood-frame. The building has shallow, boxed eaves.

Outbuildings or secondary elements (if significant, use separate form)

**Historical Information:**



**MDAH inventory Code**

County: Tippah

City: Ripley

USGS Quad map:

Survey Seq. #: 189

Ownership: Private

Interior surveyed? No

Integrity: Some changes

Style:

Form:

Sources: Sanborn maps, 1925, 1943.

Contexts:

Owner:

Photographer: David Preziosi, MHT

Photo No/Date: 4421:33 / Nov 2003

Form by: Deborah Wise Oakley, MHT--

Survey project: Ripley Survey

Form completed: 23 Jun 2004

**Registration Status and Dates**

NHL:

Listed NR:

Federal DOE:

District Name: Ripley

- Contributing  
 Non-Contributing  
 Previously Listed

Element no. 189

Hand-drawn map showing a building layout.

NORTH UNION ST.

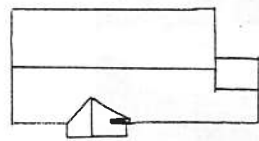

MULBERRY ST.

