

Historic Resources Inventory

Property name, historic

Property name, common:

Street Address: 119 Main Street, North

Descriptive Location (Rural address):

Legal Description: Map 643-F, Block 17, Parcel 280

Former/Historic Use: Commercial: small commercial building

Present Use: Commercial: small commercial building

Date of Construction: c. 1930

Date(s) of historic changes, if any:

Post-historic changes and date(s):

Architect:

Builder:

Brief Description:

Two-story, brick commercial building with a flat parapet and concrete cap and a 2-course sawtooth cornice. Second story has 2 paired windows that are infilled with fixed-glass with rowlock sills. Transom area has been bricked. Large cast iron piers are at the corners of the storefront and small cast iron pilasters are in antis, connected with iron step. Storefront has been recessed and consists of center double-leaf glazed, wood door with a 2-light transom flanked by a plate-glass window with a 2-light transom.

Outbuildings or secondary elements (if significant, use separate form)

Historical Information:

Pilasters are stamped "G. L. Mesker & Co., Evansville, Ind."



MDAH Inventory Code

County: Tippah

City: Ripley

USGS Quad map:

Survey Seq. #: 122

Ownership: Private

Interior surveyed? No

Integrity: Some changes

Style:

Form:

Sources: Sanborn maps, 1943.

Contexts:

Owner:

Photographer: David Preziosi, MHT

Photo No/Date: 4417:8 / Nov 2003

Form by: Deborah Wise Oakley, MHT--

Survey project: Ripley Survey

Form completed: 23 Jun 2004

Registration Status and Dates

NHL:

Listed NR:

Federal DOE:

District Name: Ripley

Contributing

Non-Contributing

Previously Listed

Element no. 122

WEST SPRING ST.

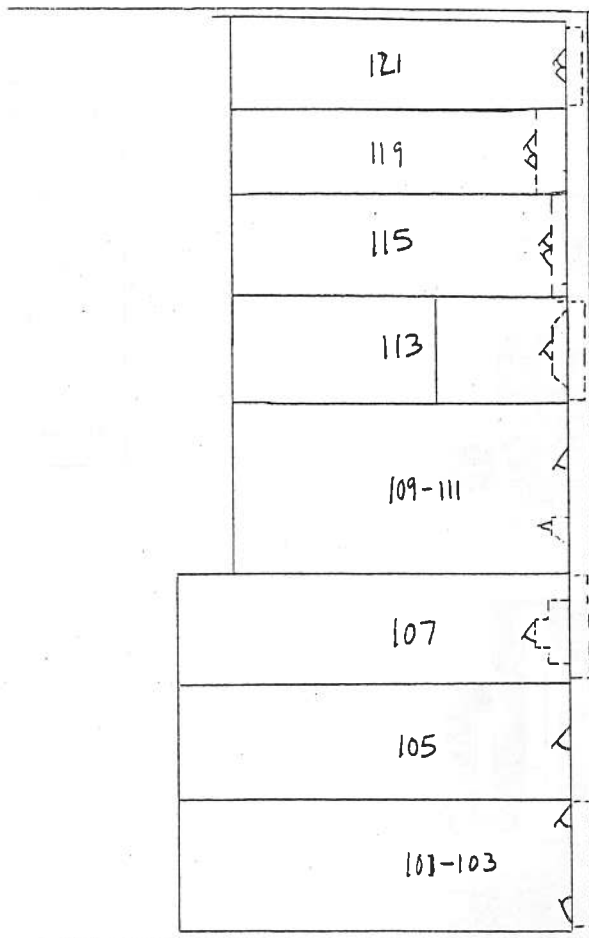

NORTH MAIN ST.

WEST JEFFERSON ST

