

Historic Resources Inventory

Property name, historic

Property name, common:

Street Address: 207 First Street, East

Descriptive Location (Rural address):

Legal Description: Map 643-K, Block 38, Parcel 76

Former/Historic Use: Residential: single dwelling

Present Use: Residential: single dwelling

Date of Construction: c.1940

Date(s) of historic changes, if any:

Post-historic changes and date(s):

Architect:

Builder:

Brief Description:

One-story, brick building with a gable roof of asphalt shingles on a brick foundation, with vinyl additions on the E and W elevations. There are vinyl fishscales in the front gable-end with paired 6-light wood-frame windows. A full-width porch under a side-gable roof shelters the façade (S) and wraps around to the E elevation, supported on brick columns with concrete caps. Under the porch, a 9-light and 1-panel wood door is flanked by a single 9/1 wood-frame window to the L and paired 9/1 wood-frame windows to the R. There are boxed vinyl eaves.

Outbuildings or secondary elements (if significant, use separate form)

Historical Information:



MDAH Inventory Code

County: Tippah

City: Ripley

USGS Quad map:

Survey Seq. #: 66

Ownership: Private

Interior surveyed? No

Integrity: Some changes

Style:

Form:

Sources: Sanborn maps, 1943.

Contexts:

Owner:

Photographer: David Preziosi, MHT

Photo No/Date: 4419:29 / Nov 2003

Form by: Deborah Wise Oakley, MHT--

Survey project: Ripley Survey

Form completed: 23 Jun 2004

Registration Status and Dates

NHL:

Listed NR:

Federal DOE:

District Name: Ripley

Contributing

Non-Contributing

Previously Listed

Element no. 66

PLAT 10 11 2003 311 - H

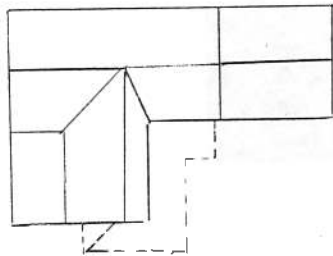

EAST FIRST STREET

SIDDAL STREET

