

Historic Resources Inventory

Property name, historic

Property name, common:

Street Address: 212 Pine Street, West

Descriptive Location (Rural address):

Legal Description: Map 643-F, Block 66, Parcel 109

Former/Historic Use: Residential: single dwelling

Present Use: Residential: single dwelling

Date of Construction: c.1925

Date(s) of historic changes, if any:

Post-historic changes and date(s):

Architect:

Builder:

Brief Description:

One-story, vinyl sided bungalow on a corner lot with a front-gable roof of standing seam metal on a brick foundation. The façade (S) has a full-width porch under a stepped gable on decorative metal posts and a concrete deck. Under the porch, 2 doors are flanked by 2 single windows. The L door is an original 3-light and 3-panel wood door, while the R is a replacement. Windows are 4/4 wood-frame.

Outbuildings or secondary elements (if significant, use separate form)

Historical Information:



MDAH Inventory Code

County: Tippah

City: Ripley

USGS Quad map:

Survey Seq. #: 206

Ownership: Private

Interior surveyed? No

Integrity: Extensive changes

Style:

Form: Bungalow

Sources: Sanborn maps, 1925, 1943.

Contexts:

Owner:

Photographer: David Preziosi, MHT

Photo No/Date: 4425:11 / Apr 2004

Form by: Deborah Wise Oakley, MHT--

Survey project: Ripley Survey

Form completed: 23 Jun 2004

Registration Status and Dates

NHL:

Listed NR:

Federal DOE:

District Name: Ripley

Contributing

Non-Contributing

Previously Listed

Element no. 206

Historic Resources

ADAMS ST.

WEST PINE ST.

ADAMS ST.

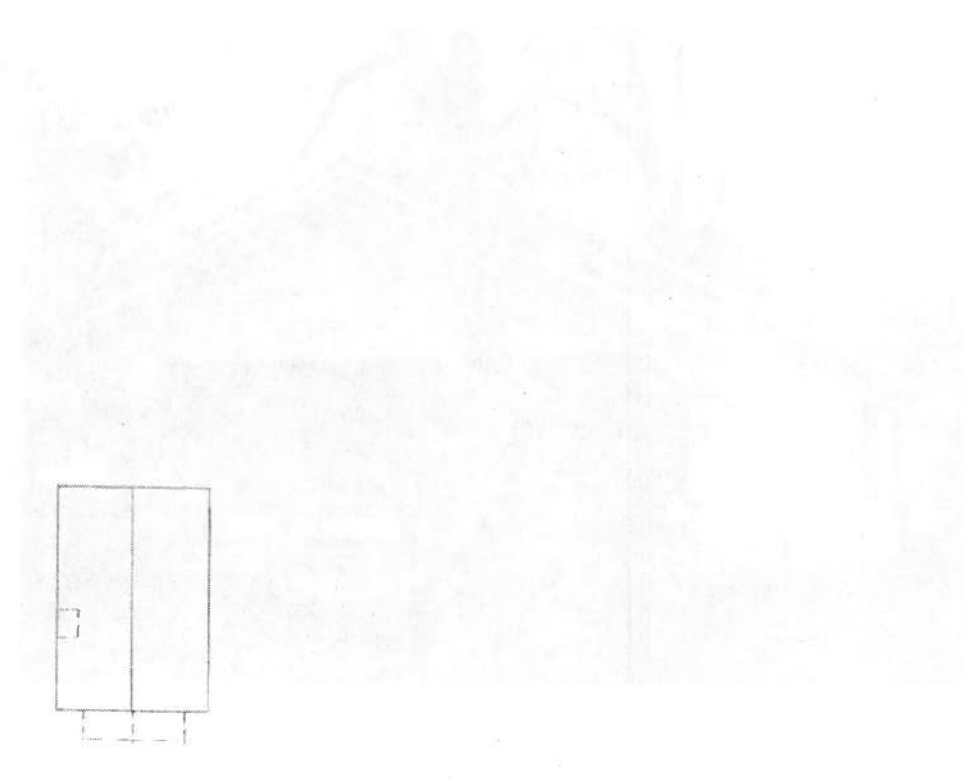

ADAMS ST.

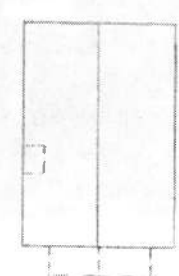

WEST PINE ST.

