

# Historic Resources Inventory

**Property name, historic**

Property name, common: Giles House

Street Address: 305 Main Street, South

Descriptive Location (Rural address):

Legal Description: Map 643-L, Block 32, Parcel 3

Former/Historic Use: Residential: single dwelling

Present Use: Residential: single dwelling

Date of Construction: c.1920

Date(s) of historic changes, if any:

Post-historic changes and date(s):

Architect:

Builder:

**Brief Description:**

One-story, clapboard bungalow with a side-gable roof of asphalt shingles. A shed dormer dominates the front slope with three, 1/1 metal frame windows. The façade (W) has a partially recessed, undercut porch to the left, supported on painted brick piers with concrete caps. Fenestration is symmetrical, with the center 6-panel wood door flanked by two paired 9/1 wood-frame windows with applied shutters. There is a continuous brick foundation and boxed vinyl eaves. There is also a painted brick chimney on the N elevation.

Outbuildings or secondary elements (if significant, use separate form)

**Historical Information:**

"Giles" was written in tile on the sidewalk.



**MDAH Inventory Code**

County: Tippah

City: Ripley

USGS Quad map:

Survey Seq. #: 158

Ownership: Private

Interior surveyed? No

Integrity: Some changes

Style:

Form: Bungalow

Sources: Sanborn maps, 1925, 1943.

Contexts:

Owner:

Photographer: David Preziosi, MHT

Photo No/Date: 4418:5 / Nov 2003

Form by: Deborah Wise Oakley, MHT--

Survey project: Ripley Survey

Form completed: 23 Jun 2004

**Registration Status and Dates**

NHL:

Listed NR:

Federal DOE:

District Name: Ripley

Contributing

Non-Contributing

Previously Listed

Element no. 158

PLAN OF ...



SOUTH MAIN ST.

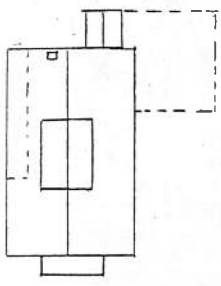

SECTION LINE