

# Historic Resources Inventory

Property name, historic

Property name, common:

Street Address: 405 Main Street, South

Descriptive Location (Rural address):

Legal Description: Map 643-L, Block 37, Parcel 50

Former/Historic Use: Residential: single dwelling

Present Use: Residential: single dwelling

Date of Construction: c.1950

Date(s) of historic changes, if any:

Post-historic changes and date(s):

Architect:

Builder:

Brief Description:

One-and-a-half story aluminum or pressed wood house with a side-gable roof of asphalt shingles and a poured concrete foundation. 3 gabled dormers dominate the front slope with 6/6/wood-frame windows. The façade (W) is symmetrical, with a center 6-panel wood door flanked by 8/8 wood-frame windows with applied shutters. The door surround has a pediment. There is a painted brick chimney and a large garage addition on the N elevation.

Outbuildings or secondary elements (if significant, use separate form)

Historical Information:



MDAH Inventory Code

County: Tippah

City: Ripley

USGS Quad map:

Survey Seq. #: 160

Ownership: Private

Interior surveyed? No

Integrity: Some changes

Style:

Form:

Sources:

Contexts:

Owner:

Photographer: David Preziosi, MHT

Photo No/Date: 4418:7 / Nov 2003

Form by: Deborah Wise Oakley, MHT

Survey project: Ripley Survey

Form completed: 23 Jun 2004

Registration Status and Dates

NHL:

Listed NR:

Federal DOE:

District Name: Ripley

Contributing

Non-Contributing

Previously Listed

Element no. 160



SOUTH MAIN ST.

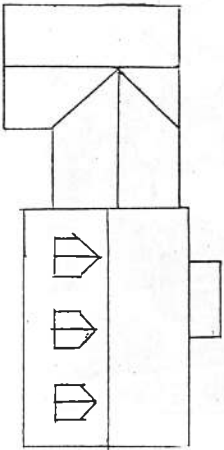

EAST THIRD ST