

Historic Resources Inventory

Property name, historic

Property name, common:

Street Address: 608 Adams Street

Descriptive Location (Rural address):

Legal Description: Map 643-F, Block 60, Parcel 101

Former/Historic Use: Residential: single dwelling

Present Use: Residential: single dwelling

Date of Construction: c. 1920

Date(s) of historic changes, if any:

Post-historic changes and date(s):

Architect:

Builder:

Brief Description:

One-story, clapboard L-front with a cross-gable roof of asphalt shingles on a brick pier foundation. 2 brick chimneys pierce the roof at the ridge. A front-facing gable and shed form a partial-width porch in the L, which is supported by turned posts. The 3 bays under the porch consist of a centered 3-light and 3-panel wood door, which is flanked by 2 single windows. The windows are 4/4 wood-frame. There is a single window in the front-facing gable. There are exposed rafters.

Outbuildings or secondary elements (If significant, use separate form)

Historical Information:

MDAH Inventory Code

County: Tippah

City: Ripley

USGS Quad map:

Survey Seq. #: 6

Ownership: Private

Interior surveyed? No

Integrity: Some changes

Style:

Form: L-front

Sources: Sanborn maps, 1925, 1943.

Contexts:

Owner:

Photographer: David Preziosi, MHT

Photo No/Date: 4425:36 / Apr 2004

Form by: Deborah Wise Oakley, MHT

Survey project: Ripley Survey

Form completed: 23 Jun 2004

Registration Status and Dates

NHL:

Listed NR:

Federal DOE:

District Name: Ripley

- Contributing
- Non-Contributing
- Previously Listed

Element no. 6



7

ADAMIS

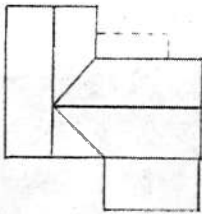

WEST NORTH