

Historic Resources Inventory

Property name, historic: Ripley 2nd Baptist Church
Property name, common: Ripley 2nd Baptist Church
Street Address: 709 Adams Street
Descriptive Location (Rural address):
Legal Description: Map 643-F, Block 54, Parcel 14
Former/Historic Use: Religious: church
Present Use: Religious: church
Date of Construction: c. 1925
Date(s) of historic changes, if any:
Post-historic changes and date(s):
Architect: **Builder:**

Brief Description:

One-story, textured brick church, of a traditional T-plan with a front-gable of modern, raised seam metal, with a small wooden steeple on a brick foundation. An central entrance on the E façade is on a slight wall projection and is sheltered under a front-gable porch, which is supported by tapered wood columns. The entrance consists of 2-light and 4-panel wood doors with a blind, Gothic arch above. Flanking the porch are two, 1/1 wood-frame windows with concrete sills. The building appears to have been rebricked c. 1950. There are boxed, vinyl eaves.

Outbuildings or secondary elements (if significant, use separate form)

Historical Information:

MDAH Inventory Code

County: Tippah
City: Ripley
USGS Quad map:
Survey Seq. #: 8
Ownership: Private
Interior surveyed? No
Integrity: Some changes
Style:
Form:

Sources: Sanborn maps, 1925, 1943.

Contexts:

Owner:

Photographer: David Preziosi, MHT

Photo No/Date: 4426:6-7 / Apr 2004

Form by: Deborah Wise Oakley, MHT

Survey project: Ripley Survey

Form completed: 23 Jun 2004

Registration Status and Dates

NHL:

Listed NR:

Federal DOE:

District Name: Ripley

- Contributing
- Non-Contributing
- Previously Listed

Element no. 8



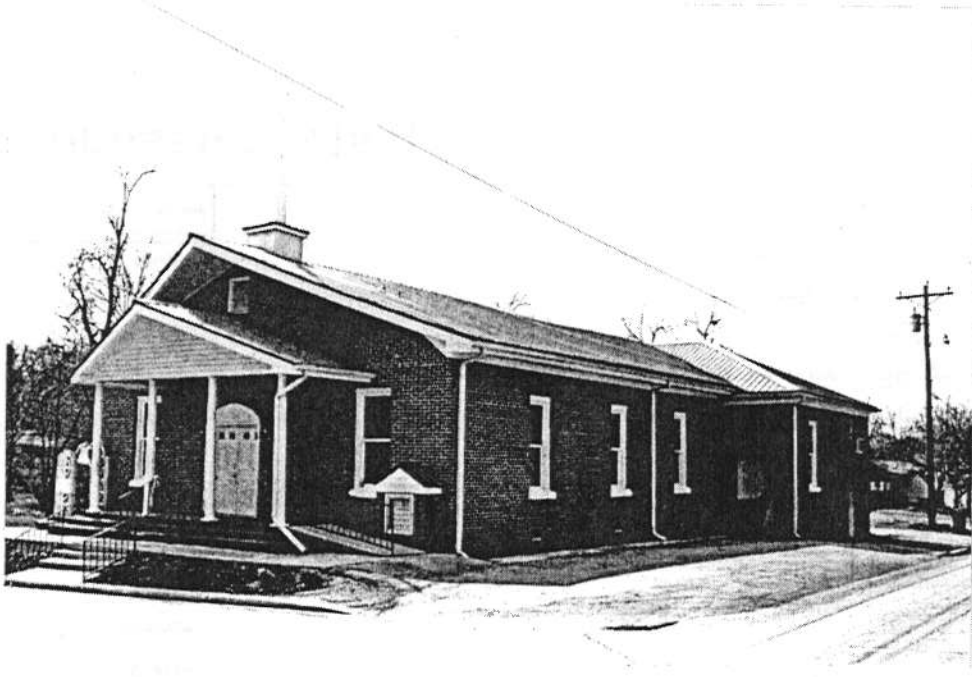

TERRY ROAD

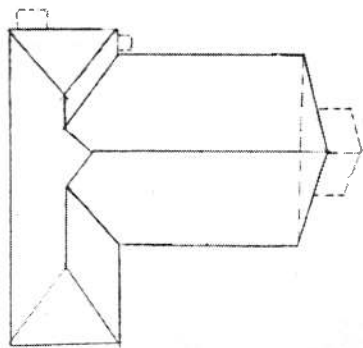

ADAMS

