

# Historic Resources Inventory

Property name, historic

Property name, common:

Street Address: 713 Main Street, South

Descriptive Location (Rural address):

Legal Description: Map 643-L, Block 48, Parcel 152

Former/Historic Use: Residential: single dwelling

Present Use: Residential: single dwelling

Date of Construction: c.1925

Date(s) of historic changes, if any:

Post-historic changes and date(s):

Architect:

Builder:

Brief Description:

One-story, narrow clapboard or O-G bungalow with a front-gable roof of asphalt shingles on a painted brick foundation. There are two 6-light wood-frame windows and asbestos shingles in the gable end. A side-gabled porch shelters the left two-thirds of the façade (W), wrapping around to the N elevation, and resting on battered boxed columns atop brick piers with concrete caps. The façade has 3 symmetrical bays, with a 15-light centered, wood door flanked by paired 9/1 wood-frame windows. There are exposed rafters and 2 interior brick chimneys.

Outbuildings or secondary elements (if significant, use separate form)

Gabled, frame garage to the N rear. (C)

Historical Information:



MDAH Inventory Code

County: Tippah

City: Ripley

USGS Quad map:

Survey Seq. #: 181

Ownership: Private

Interior surveyed? No

Integrity: Some changes

Style:

Form: Bungalow

Sources:

Contexts:

Owner:

Photographer: David Preziosi, MHT

Photo No/Date: 4418:32 / Nov 2003

Form by: Deborah Wise Oakley, MHT--

Survey project: Ripley Survey

Form completed: 23 Jun 2004

Registration Status and Dates

NHL:

Listed NR:

Federal DOE:

District Name: Ripley

Contributing

Non-Contributing

Previously Listed

Element no. 181

10/10/2020

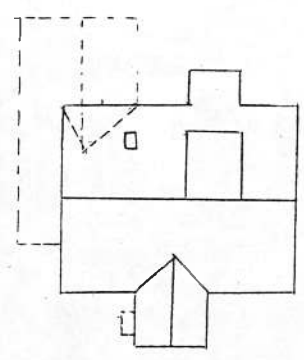

1  
7