

Historic Resources Inventory

Property name, historic

Property name, common:

Street Address: 714 Main Street, South

Descriptive Location (Rural address):

Legal Description: Map 643-L, Block 49, Parcel 155

Former/Historic Use: Residential: single dwelling

Present Use: Residential: single dwelling

Date of Construction: c.1925

Date(s) of historic changes, if any:

Post-historic changes and date(s):

Architect:

Builder:

Brief Description:

One-story, brick with a front-gable roof of pressed-metal shingles on a brick foundation. A full-width porch is under a gable-and-hip roof, atop brick columns on brick piers connected by a low knee wall, all with concrete caps. A 6-panel wood door is off-center and flanked by an enclosed single window on the left and 2 paired, fixed, plate-glass window (in place of original 2 windows) to the right. The original 6/6 wood-frame windows with concrete sills can still be seen on the N and S elevations.

Outbuildings or secondary elements (if significant, use separate form)

Historical Information:



MDAH Inventory Code

County: Tippah

City: Ripley

USGS Quad map:

Survey Seq. #: 182

Ownership: Private

Interior surveyed? No

Integrity: Some changes

Style:

Form:

Sources:

Contexts:

Owner:

Photographer: David Preziosi, MHT

Photo No/Date: 4496:16 / Aug 2004

Form by: Deborah Wise Oakley, MHT

Survey project: Ripley Survey

Form completed: 23 Jun 2004

Registration Status and Dates

NHL:

Listed NR:

Federal DOE:

District Name: Ripley

Contributing

Non-Contributing

Previously Listed

Element no. 182

PLANNING DEPARTMENT

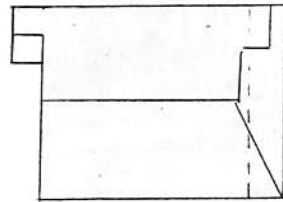

SOUTH MAIN ST.

